

# Site plan

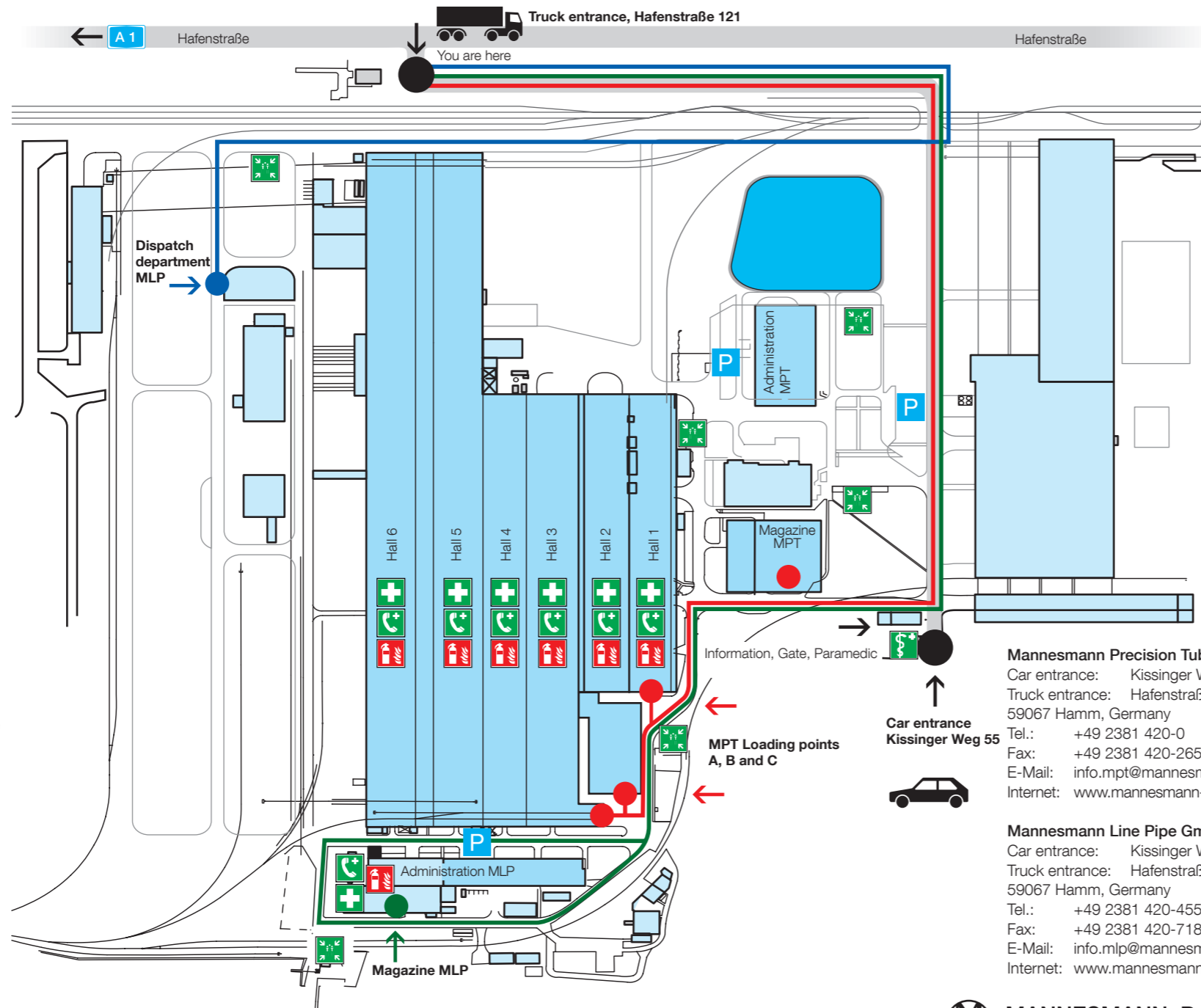

## Truck route to pick up:

- Mannesmann Precision Tubes
- Mannesmann Line Pipe
- Parcel services
- Gathering place
- First Aid
- Emergency telephone
- Medical centre
- Fire drencher
- Parking

**Mannesmann Precision Tubes GmbH**  
 Car entrance: Kissinger Weg 55  
 Truck entrance: Hafenstraße 121  
 59067 Hamm, Germany  
 Tel.: +49 2381 420-0  
 Fax: +49 2381 420-265  
 E-Mail: info.mpt@mannesmann.com  
 Internet: www.mannesmann-precision-tubes.com

**Mannesmann Line Pipe GmbH**  
 Car entrance: Kissinger Weg 55  
 Truck entrance: Hafenstraße 121  
 59067 Hamm, Germany  
 Tel.: +49 2381 420-455  
 Fax: +49 2381 420-718  
 E-Mail: info.mlp@mannesmann.com  
 Internet: www.mannesmann-linepipe.com

**MANNESMANN. Das Rohr.**  
 www.mannesmann.de



## Information for visitors



**MANNESMANN  
PRECISION TUBES**  
 A Member of the Salzgitter Group

**MANNESMANN  
LINE PIPE**  
 A Member of the Salzgitter Group



## Truck entrance Hafenstraße



- Press the lit button to request an ID card.

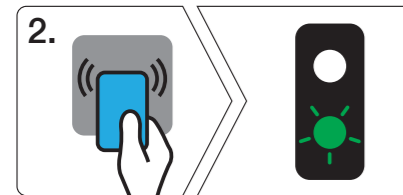

- Remove the ID card and hold it in front of the reader next to the lit button.
- At green traffic light and opened barrier, you can drive to the factory terrain.

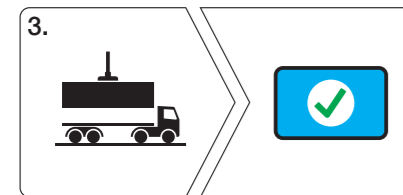

- Important! Make sure that your ID card is unlocked at the loading point for the exit. An exit without activation is not possible!

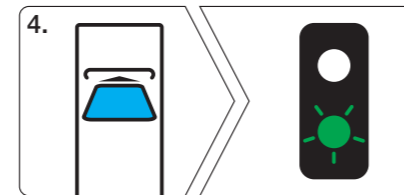

- At the exit, enter the ID card into the exit terminal.
- With green traffic light and opened barrier, you can leave the factory terrain.

## Safety advice for truck drivers

- Road traffic on these premises is subject to German traffic regulations (StVO).
- Rail traffic has right of way.
- Do not stop on railways crossing! Keep a minimum distance of 1,75 m to rail tracks.
- Reversing lorries must be guided by an assisting person.
- Drivers and passengers must not remain in vehicle during loading/unloading. The specific protective clothing must be worn.

## Other instructions

- Visitors have to sign in by the security staff at the front gate. Keep off the production-hall. A host will take care of you and show you the factory.
- Plant Security must be informed of traffic accidents or other damage (phone: +49 2381 420-652). Fire, other accidents and necessary assistance call the emergency number +49 2381 420-112.
- In an event of a fire, a siren will sound, go immediately to a designated assembly point and wait for further instructions.
- The personal data of the visitors are stored for a maximum of one year. (Note on data protection). If the visitor card is lost or irreparably damaged, Mannesmann Precision Tubes GmbH reserves the right to charge a fee of 50 EUR.
- They will receive a visitor card from the gatekeeper to enter the factory area. The visitor card must be worn visibly at all times. At the end of the visit, the visitor's card is withdrawn at the exits of the Kissinger Weg gate.

-  Use serviceable footwear only!
-  Wear a safety helmet and ear protectors.
-  Stay on the path and remain with your group.
-  Use handrails when going up or down stairs.
-  Photographing or filming are not permitted.
-  Please secure your tie or scarf.
-  Persons wearing pacemakers can not come on the tour.
-  Alcohol and other intoxicant drugs may not be brought into or consumed on the premises.
-  Never touch moving machine parts or products!

## Important telephone numbers

- Porter: - 652
- Paramedic:
- Emergency phone: - 112